

DN900 Dredge Ball Joints



DN900 dredge ball joint key features:

1. Pipe through ball construction
2. Ball joint to be welded to the dredge pipe
3. Low maintenance required
4. Exchangeable case liner
5. Exchangeable rubber seal
6. Ball joint can be customized to client's requirements

Materials used:

Ball:	ZG30Mn
Case:	ZG30Mn
Gland:	ZG30Mn
Liner:	ZG30Mn
Seal:	NBR
Lock:	Q345

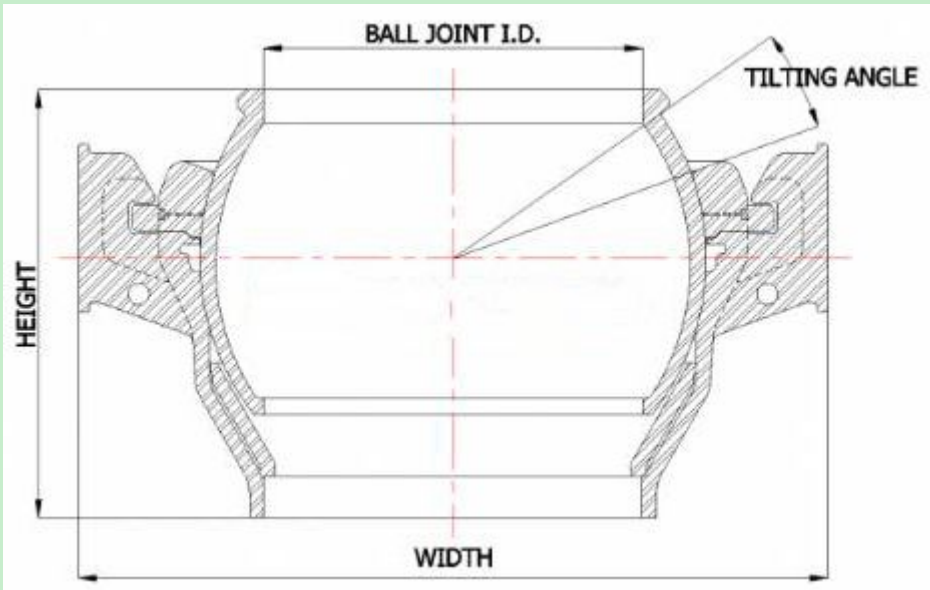

DN900 dredge ball joints drawing

Technical Specifications

15 Degrees tilting angle										
		10 Bar			20 Bar			30 Bar		
Pipe ID (mm)	Ball joint ID (mm)	Height (mm)	Width (mm)	Weight (kg)	Height (mm)	Width (mm)	Weight (kg)	Height (mm)	Width (mm)	Weight (kg)
900	954	900	1,766	2,611	1,088	1,891	3,659	1,237	2,000	4,788

18 Degrees tilting angle										
		10 Bar			20 Bar			30 Bar		
Pipe ID (mm)	Ball joint ID (mm)	Height (mm)	Width (mm)	Weight (kg)	Height (mm)	Width (mm)	Weight (kg)	Height (mm)	Width (mm)	Weight (kg)
900	954	1,076	1,974	3,839	1,282	2,134	5,610	1,465	2,264	7,308

Chongqing Hi-Sea Marine Equipment Import&Export Co.,Ltd.

Address: 20-5,General Chamber of Commerce Building, No.2 Hongjin Street, Yubei District, Chongqing, China

Email: machine@hiseamarine.com mitang0708@foxmail.com **Skype:** cncqtang **QQ:** 2278612160

TEL: +86-23-67032301 **FAX:**+86-23-67955123 **Mobile:** +86-18108354610 **Post Code:**401147

Website: www.hiseamarine.com www.chinahisea.com