



## Single cruciform bollard

### 1. Product description

Nominal size of single cruciform bollards: 50mm, 75mm, 100mm

Nominal size of double cruciform bollards: 50mm, 75mm, 100mm, 125mm, 150mm, 175mm, 200mm, 250mm, 300mm

Our bollards can be used for steel cables and ropes.

Nice shaped, good quality and with very low maintenance.

LR, BV, CCS Certificate could be provided

We also customize bollard products for special requirements.

### 2. Core attributes:

- A. High quality SG iron as standard
- B. Strong and durable designs
- C. Very low maintenance
- D. Large line angles possible
- E. Standard and custom anchors available
- F. Specification and Type

G. Bollards are manufactured in a wide range of shapes, sizes and capabilities. In general, the type bollard should always well as the general size ( i.e. height, head size, base size, etc) and load capacity.

Every enquiry from you will receive our prompt attention. kindly welcome to contact me directly.

### 3.Drawing

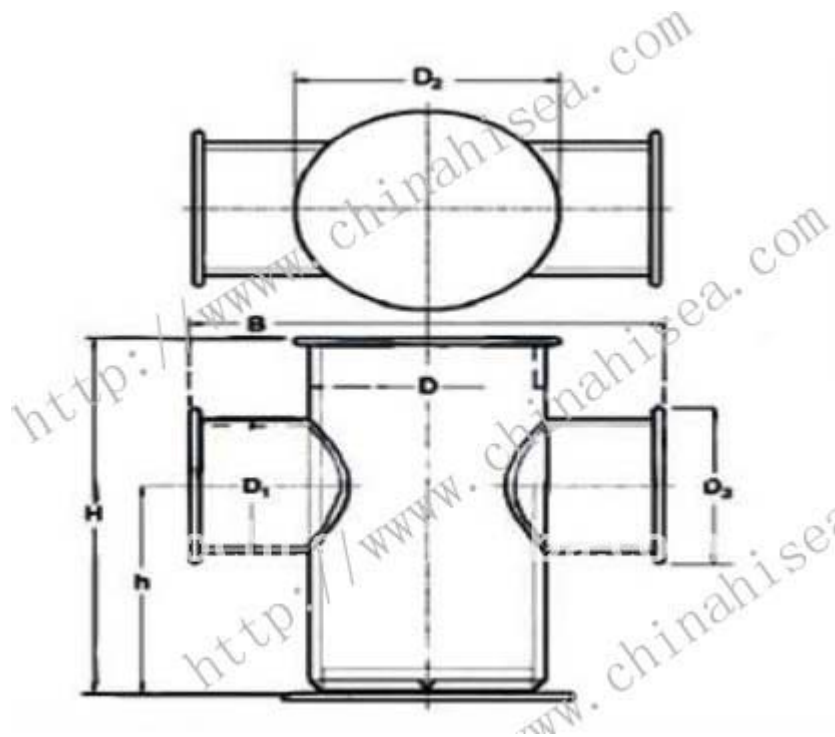

### 4.Specification

| Nominal Dia.(mm) | Dimension(mm) |     |     |     |     |     |     | Weight(kg) | Wire Rope D |
|------------------|---------------|-----|-----|-----|-----|-----|-----|------------|-------------|
|                  | H             | h   | B   | D   | D1  | D2  | D3  |            |             |
| 150              | 480           | 280 | 460 | 165 | 114 | 206 | 158 | 33         | 16          |
| 200              | 560           | 320 | 520 | 216 | 165 | 256 | 206 | 60         | 22          |
| 250              | 640           | 360 | 610 | 267 | 216 | 308 | 256 | 102        | 28          |
| 300              | 680           | 380 | 660 | 318 | 267 | 360 | 308 | 154        | 34          |
| 350              | 720           | 420 | 720 | 355 | 267 | 400 | 312 | 186        | 38          |