

Dredge Turning Gland



Dredge Turning Gland Features and Benefits:

The Dredge turning gland is designed by modular principle for heavy duty operation in any type of soil anywhere in the world. The Dredge turning gland enables the draghead to better follow the sea bottom or ocean floor. The Dredge turning gland allows a radial rotation in both directions of 15°. The Dredge turning gland consists of an inner and an outer pipe and has mechanical stops to limit rotation. Two bearings and a sealing make for a trouble-free use.

1. The dredge turning glands has adjustable turning angle
2. All flanges are cast together with the body of the pipes
3. All major components of dredge turning gland are cast designs
4. A rubber lip seal is used for the sealing of the dredge turning glands
5. Accurate machining and smooth machining surface of all parts is achieved to ensure sliding properties
6. The dredge turning gland has a compact seal design making the design less heavier

Size of Dredge Turning Gland

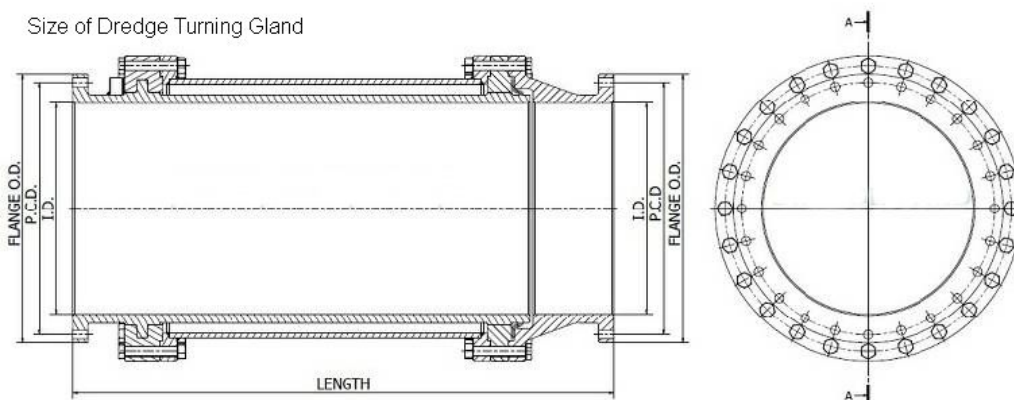

7. Dredge turning glands sliding rings are made from iron for better sliding factor
8. Adjustable turning range by using dismountable stoppers
9. Heavy duty design using minimal pipe wall thickness of 30 mm

Technical specifications

Pipe Inside Diameter (mm)	Outside Diameter (OD)	Pitch Circle Diameter (P.C.D)	Diameter of Bolt Hole	Bolt Quantity	Bolt Size	Flange Thickness	Over all Length	Total Weight (kg)
500	670	620	26	20	M24	38	1,500	1,320
600	780	725	30	20	M27	42	1,650	1,770
700	895	840	30	24	M27	50	1,800	2,382
800	1,015	950	33	24	M30	56	1,850	3,059
900	1,115	1,050	33	28	M30	62	1,900	3,652
1,000	1,230	1,160	36	28	M33	70	1,950	4,393
1,100	1,275	1,220	36	28	M33	76	2,000	5,047
1,200	1,455	1,380	39	32	M36	83	2,050	5,610
1,300	1,560	1,480	39	32	M36	83	2,100	6,753
1,400	1,675	1,590	42	36	M39	83	2,150	7,471

Note: According to user's or design and manufacturing drawing.



Dredge Turning Gland Quality Control:

Dredge turning glands are designed, produced and tested under strict ISO and ASTM standards and doubled tested at third party for verification.



Dredge Turning Gland Ready to shipping



maintenance and installation

Chongqing Hi-Sea Marine Equipment Import&Export Co.,Ltd.

Address: 20-5,General Chamber of Commerce Building, No.2 Hongjin Street, Yubei District, Chongqing, China

Email: machine@hiseamarine.com mitang0708@foxmail.com **Skype:** cncqtang **QQ:** 2278612160

TEL: +86-23-67032301 **FAX:**+86-23-67955123 **Mobile:** +86-18108354610 **Post Code:**401147

Website: www.hiseamarine.com www.chinahisea.com