

B16.47 Series A Class 150 Weld Neck & Blind

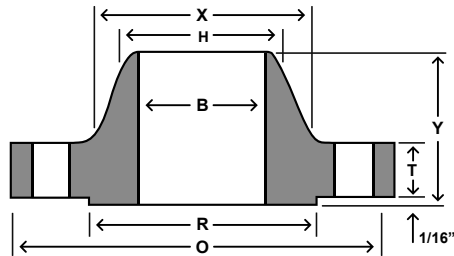

WELD NECK

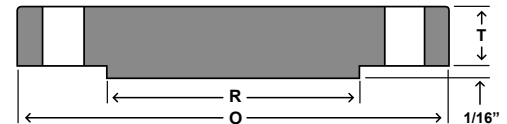

BLIND

| Nom Size | Thickness | | | | | | | | Drilling | | | | Weight | |
|----------|-----------|-----------|-------|----------|-------------|------|------|-----------|-------------|-------------|----------|------------|-----------|-------|
| | OD | Weld Neck | Blind | OD of RF | Dia at Base | Bore | LTH | Dia Bevel | Bolt Circle | Bolt Length | Hole Dia | # of Holes | Weld Neck | Blind |
| | O | T | T | R | X | B | Y | H | | (A) | (B) | | | |
| 26 | 34.25 | 2.63 | 2.63 | 29.50 | 26.62 | | 4.69 | 26.00 | 31.75 | 8.75 | 1.38 | 24 | 300 | 702 |
| 28 | 36.50 | 2.75 | 2.75 | 31.50 | 28.62 | | 4.88 | 28.00 | 34.00 | 9.00 | 1.38 | 28 | 345 | 833 |
| 30 | 38.75 | 2.88 | 2.88 | 33.75 | 30.75 | | 5.32 | 30.00 | 36.00 | 9.25 | 1.38 | 28 | 400 | 982 |
| 32 | 41.75 | 3.13 | 3.13 | 36.00 | 32.75 | | 5.63 | 32.00 | 38.50 | 10.50 | 1.62 | 28 | 505 | 1237 |
| 34 | 43.75 | 3.19 | 3.19 | 38.00 | 34.75 | | 5.82 | 34.00 | 40.50 | 10.50 | 1.62 | 32 | 540 | 1384 |
| 36 | 46.00 | 3.50 | 3.50 | 40.25 | 36.75 | | 6.13 | 36.00 | 42.75 | 11.00 | 1.62 | 32 | 640 | 1676 |
| 38 | 48.75 | 3.38 | 3.38 | 42.25 | 39.00 | | 6.13 | 38.00 | 45.25 | 11.00 | 1.62 | 32 | 720 | 1819 |
| 40 | 50.75 | 3.50 | 3.50 | 44.25 | 41.00 | | 6.38 | 40.00 | 47.25 | 11.00 | 1.62 | 36 | 775 | 2040 |
| 42 | 53.00 | 3.75 | 3.75 | 47.00 | 43.00 | | 6.69 | 42.00 | 49.50 | 11.50 | 1.62 | 36 | 890 | 2381 |
| 44 | 55.25 | 3.94 | 3.94 | 49.00 | 45.00 | | 6.94 | 44.00 | 51.75 | 12.00 | 1.62 | 40 | 990 | 2717 |
| 46 | 57.25 | 4.00 | 4.00 | 51.00 | 47.12 | | 7.25 | 46.00 | 53.75 | 12.00 | 1.62 | 40 | 1060 | 2961 |
| 48 | 59.50 | 4.19 | 4.19 | 53.50 | 49.12 | | 7.50 | 48.00 | 56.00 | 12.50 | 1.62 | 44 | 1185 | 3348 |
| 50 | 61.75 | 4.32 | 4.32 | 55.50 | 51.25 | | 7.94 | 50.00 | 58.25 | 13.25 | 1.88 | 44 | 1270 | 3716 |
| 52 | 64.00 | 4.50 | 4.50 | 57.50 | 53.25 | | 8.19 | 52.00 | 60.50 | 13.75 | 1.88 | 44 | 1410 | 4156 |
| 54 | 66.25 | 4.69 | 4.69 | 59.50 | 55.25 | | 8.44 | 54.00 | 62.75 | 14.00 | 1.88 | 44 | 1585 | 4639 |
| 56 | 68.75 | 4.82 | 4.82 | 62.00 | 57.38 | | 8.94 | 56.00 | 65.00 | 14.25 | 1.88 | 48 | 1760 | 5132 |
| 58 | 71.00 | 5.00 | 5.00 | 64.00 | 59.38 | | 9.19 | 58.00 | 67.25 | 14.75 | 1.88 | 48 | 1915 | 5675 |
| 60 | 73.00 | 5.13 | 5.13 | 66.00 | 61.38 | | 9.38 | 60.00 | 69.25 | 15.00 | 1.88 | 52 | 2045 | 6154 |

To be specified by Purchaser.

DIMENSIONS ARE IN INCHES / WEIGHTS ARE IN POUNDS

(A) Bolt lengths are calculated based on bolting one WN to one Blind

(B) Bolt diameter should be 1/8" less than the bolt hole diameter

(C) Larger sizes as well as intermediate sizes can be furnished

B16.47 Series A Class 300 Weld Neck & Blind

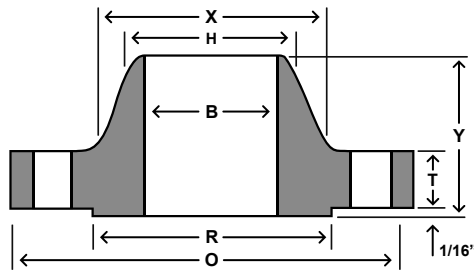

WELD NECK

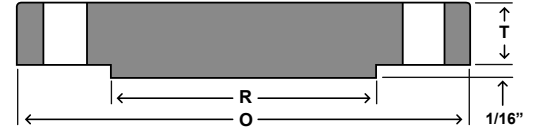

BLIND

| Nom Size | Thickness | | | | | | | | Drilling | | | | Weight | |
|----------|-----------|-----------|-------|----------|-------------|------|-------|-----------|-------------|-------------|----------|------------|-----------|-------|
| | OD | Weld Neck | Blind | OD of RF | Dia at Base | Bore | LTH | Dia Bevel | Bolt Circle | Bolt Length | Hole Dia | # of Holes | Weld Neck | Blind |
| | O | T | T | R | X | B | Y | H | | (A) | (B) | | | |
| 26 | 38.25 | 3.07 | 3.25 | 29.50 | 28.38 | | 7.19 | 26.00 | 34.50 | 10.75 | 1.75 | 28 | 605 | 1078 |
| 28 | 40.75 | 3.32 | 3.50 | 31.50 | 30.50 | | 7.69 | 28.00 | 37.00 | 11.25 | 1.75 | 28 | 745 | 1315 |
| 30 | 43.00 | 3.57 | 3.69 | 33.75 | 32.56 | | 8.19 | 30.00 | 39.25 | 12.00 | 1.88 | 28 | 870 | 1543 |
| 32 | 45.25 | 3.82 | 3.88 | 36.00 | 34.69 | | 8.69 | 32.00 | 41.50 | 12.50 | 2.00 | 28 | 1005 | 1795 |
| 34 | 47.50 | 3.94 | 4.07 | 38.00 | 36.88 | | 9.07 | 34.00 | 43.50 | 13.00 | 2.00 | 28 | 1145 | 2068 |
| 36 | 50.00 | 4.07 | 4.32 | 40.25 | 39.00 | | 9.44 | 36.00 | 46.00 | 13.50 | 2.12 | 32 | 1275 | 2436 |
| 38 | 46.00 | 4.19 | 4.19 | 40.50 | 39.12 | | 7.06 | 38.00 | 43.00 | 12.50 | 1.62 | 32 | 695 | 2001 |
| 40 | 48.75 | 4.44 | 4.44 | 42.75 | 41.25 | | 7.56 | 40.00 | 45.50 | 13.25 | 1.75 | 32 | 840 | 2380 |
| 42 | 50.75 | 4.63 | 4.63 | 44.75 | 43.25 | | 7.82 | 42.00 | 47.50 | 13.75 | 1.75 | 32 | 950 | 2688 |
| 44 | 53.25 | 4.82 | 4.82 | 47.00 | 45.25 | | 8.06 | 44.00 | 49.75 | 14.25 | 1.88 | 32 | 1055 | 3079 |
| 46 | 55.75 | 5.00 | 5.00 | 49.00 | 47.38 | | 8.44 | 46.00 | 52.00 | 15.00 | 2.00 | 28 | 1235 | 3499 |
| 48 | 57.75 | 5.19 | 5.19 | 51.25 | 49.38 | | 8.75 | 48.00 | 54.00 | 15.25 | 2.00 | 32 | 1380 | 3896 |
| 50 | 60.25 | 5.44 | 5.44 | 53.50 | 51.38 | | 9.07 | 50.00 | 56.25 | 16.00 | 2.12 | 32 | 1530 | 4442 |
| 52 | 62.25 | 5.63 | 5.63 | 55.50 | 53.38 | | 9.32 | 52.00 | 58.25 | 16.50 | 2.12 | 32 | 1660 | 4906 |
| 54 | 65.25 | 5.94 | 5.94 | 57.75 | 55.50 | | 9.88 | 54.00 | 61.00 | 17.50 | 2.38 | 28 | 2050 | 5684 |
| 56 | 67.25 | 6.00 | 6.00 | 59.75 | 57.62 | | 10.19 | 56.00 | 63.00 | 17.75 | 2.38 | 28 | 2155 | 6098 |
| 58 | 69.25 | 6.19 | 6.19 | 62.00 | 59.62 | | 10.44 | 58.00 | 65.00 | 18.00 | 2.38 | 32 | 2270 | 6669 |
| 60 | 71.25 | 6.38 | 6.38 | 64.00 | 61.62 | | 10.69 | 60.00 | 67.00 | 18.50 | 2.38 | 32 | 2470 | 7274 |

To be specified by Purchaser.

DIMENSIONS ARE IN INCHES | WEIGHTS ARE IN POUNDS

(A) Bolt lengths are calculated based on bolting one WN to one Blind

(B) Bolt diameter should be 1/8" less than the bolt hole diameter

(C) Larger sizes as well as intermediate sizes can be furnished

B16.47 Series A Class 400 Weld Neck & Blind

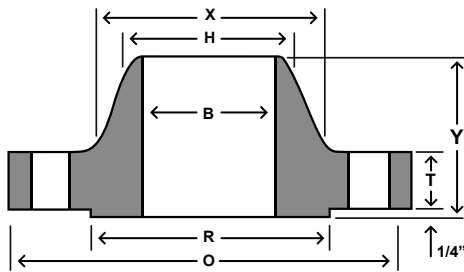

WELD NECK

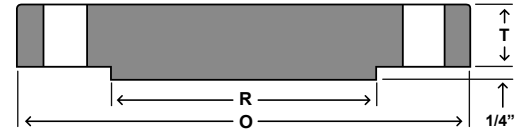

BLIND

| Nom Size | Thickness | | | Drilling | | | | | | | | | Weight | |
|----------|-----------|-----------|-------|----------|-------------|------|-------|-----------|-------------|-------------|----------|------------|-----------|-------|
| | OD | Weld Neck | Blind | OD of RF | Dia at Base | Bore | LTH | Dia Bevel | Bolt Circle | Bolt Length | Hole Dia | # of Holes | Weld Neck | Blind |
| | O | T | T | R | X | B | Y | H | | (A) | (B) | | | |
| 26 | 38.25 | 3.50 | 3.88 | 29.50 | 28.62 | | 7.62 | 26.00 | 34.50 | 12.50 | 1.88 | 28 | 650 | 1263 |
| 28 | 40.75 | 3.75 | 4.12 | 31.50 | 30.81 | | 8.12 | 28.00 | 37.00 | 13.25 | 2.00 | 28 | 785 | 1522 |
| 30 | 43.00 | 4.00 | 4.38 | 33.75 | 32.94 | | 8.62 | 30.00 | 39.25 | 14.00 | 2.12 | 28 | 905 | 1802 |
| 32 | 45.25 | 4.25 | 4.56 | 36.00 | 35.00 | | 9.12 | 32.00 | 41.50 | 14.25 | 2.12 | 28 | 1065 | 2077 |
| 34 | 47.50 | 4.38 | 4.81 | 38.00 | 37.19 | | 9.50 | 34.00 | 43.50 | 14.75 | 2.12 | 28 | 1200 | 2415 |
| 36 | 50.00 | 4.50 | 5.06 | 40.25 | 39.38 | | 9.88 | 36.00 | 46.00 | 15.00 | 2.12 | 32 | 1340 | 2815 |
| 38 | 47.50 | 4.88 | 4.88 | 40.75 | 39.50 | | 8.12 | 38.00 | 44.00 | 14.75 | 1.88 | 32 | 935 | 2450 |
| 40 | 50.00 | 5.12 | 5.12 | 43.00 | 41.50 | | 8.50 | 40.00 | 46.25 | 15.50 | 2.00 | 32 | 1090 | 2848 |
| 42 | 52.00 | 5.25 | 5.25 | 45.00 | 43.62 | | 8.81 | 42.00 | 48.25 | 15.75 | 2.00 | 32 | 1190 | 3159 |
| 44 | 54.50 | 5.50 | 5.50 | 47.25 | 45.62 | | 9.18 | 44.00 | 50.50 | 16.50 | 2.12 | 32 | 1375 | 3635 |
| 46 | 56.75 | 5.75 | 5.75 | 49.50 | 47.75 | | 9.62 | 46.00 | 52.75 | 17.00 | 2.12 | 36 | 1525 | 4120 |
| 48 | 59.50 | 6.00 | 6.00 | 51.50 | 49.88 | | 10.12 | 48.00 | 55.25 | 18.00 | 2.38 | 28 | 1790 | 4726 |
| 50 | 61.75 | 6.19 | 6.25 | 53.62 | 52.00 | | 10.56 | 50.00 | 57.50 | 18.50 | 2.38 | 32 | 1950 | 5303 |
| 52 | 63.75 | 6.38 | 6.44 | 55.62 | 54.00 | | 10.88 | 52.00 | 59.50 | 18.75 | 2.38 | 32 | 2125 | 5823 |
| 54 | 67.00 | 6.69 | 6.75 | 57.88 | 56.12 | | 11.38 | 54.00 | 62.25 | 20.00 | 2.62 | 28 | 2565 | 6742 |
| 56 | 69.00 | 6.88 | 6.94 | 60.12 | 58.25 | | 11.75 | 56.00 | 64.25 | 20.25 | 2.62 | 32 | 2710 | 7352 |
| 58 | 71.00 | 7.00 | 7.12 | 62.12 | 60.25 | | 12.06 | 58.00 | 66.25 | 20.50 | 2.62 | 32 | 3230 | 7986 |
| 60 | 74.25 | 7.31 | 7.44 | 64.38 | 62.38 | | 12.56 | 60.00 | 69.00 | 21.75 | 2.88 | 32 | 3820 | 9126 |

To be specified by Purchasr.

DIMENSIONS ARE IN INCHES | WEIGHTS ARE IN POUNDS

(A) Bolt lengths are calculated based on bolting one WN to one Blind

(B) Bolt diameter should be 1/8" less than the bolt hole diameter

B16.47 Series A Class 600 Weld Neck & Blind

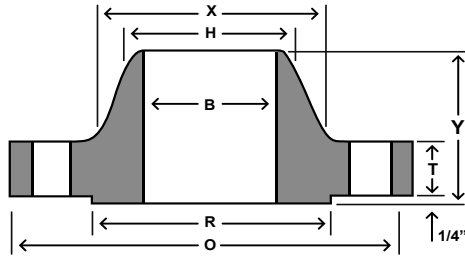

WELD NECK

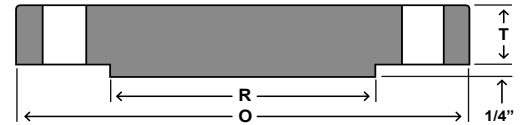

BLIND

| Nom Size | Thickness | | | | | | | | Drilling | | | | Weights | |
|----------|-----------|-----------|-------|----------|-------------|------|-------|-----------|-------------|-------------|----------|------------|-----------|-------|
| | OD | Weld Neck | Blind | OD of RF | Dia at Base | Bore | LTH | Dia Bevel | Bolt Circle | Bolt Length | Hole Dia | # of Holes | Weld Neck | Blind |
| | O | T | T | R | X | B | Y | H | | (A) | (B) | | | |
| 26 | 40.00 | 4.25 | 4.94 | 29.50 | 29.44 | | 8.75 | 26.00 | 36.00 | 14.50 | 2.00 | 28 | 940 | 1759 |
| 28 | 42.25 | 4.38 | 5.19 | 31.50 | 31.62 | | 9.25 | 28.00 | 38.00 | 15.00 | 2.12 | 28 | 1060 | 2061 |
| 30 | 44.50 | 4.50 | 5.50 | 33.75 | 33.94 | | 9.75 | 30.00 | 40.25 | 15.50 | 2.12 | 28 | 1210 | 2423 |
| 32 | 47.00 | 4.62 | 5.81 | 36.00 | 36.12 | | 10.25 | 32.00 | 42.50 | 16.50 | 2.38 | 28 | 1375 | 2856 |
| 34 | 49.00 | 4.75 | 6.06 | 38.00 | 38.31 | | 10.62 | 34.00 | 44.50 | 16.75 | 2.38 | 28 | 1540 | 3237 |
| 36 | 51.75 | 4.88 | 6.38 | 40.25 | 40.62 | | 11.12 | 36.00 | 47.00 | 17.75 | 2.62 | 28 | 1705 | 3802 |
| 38 | 50.00 | 6.00 | 6.12 | 41.50 | 40.25 | | 10.00 | 38.00 | 45.75 | 18.25 | 2.38 | 28 | 1470 | 3404 |
| 40 | 52.00 | 6.25 | 6.38 | 43.75 | 42.25 | | 10.38 | 40.00 | 47.75 | 18.75 | 2.38 | 32 | 1630 | 3838 |
| 42 | 55.25 | 6.62 | 6.75 | 46.00 | 44.38 | | 11.00 | 42.00 | 50.50 | 19.75 | 2.62 | 28 | 2030 | 4585 |
| 44 | 57.25 | 6.81 | 7.00 | 48.25 | 46.50 | | 11.38 | 44.00 | 52.50 | 20.25 | 2.62 | 32 | 2160 | 5105 |
| 46 | 59.50 | 7.06 | 7.31 | 50.25 | 48.62 | | 11.81 | 46.00 | 54.75 | 20.75 | 2.62 | 32 | 2410 | 5758 |
| 48 | 62.75 | 7.44 | 7.69 | 52.50 | 50.75 | | 12.44 | 48.00 | 57.50 | 22.25 | 2.88 | 32 | 2855 | 6737 |
| 50 | 65.75 | 7.75 | 8.00 | 54.50 | 52.88 | | 12.94 | 50.00 | 60.00 | 23.25 | 3.12 | 28 | 3330 | 7695 |
| 52 | 67.75 | 8.00 | 8.25 | 56.50 | 54.88 | | 13.25 | 52.00 | 62.00 | 23.75 | 3.12 | 32 | 3560 | 8426 |
| 54 | 70.00 | 8.25 | 8.56 | 58.75 | 57.00 | | 13.75 | 54.00 | 64.25 | 24.25 | 3.12 | 32 | 3920 | 9333 |
| 56 | 73.00 | 8.56 | 8.88 | 60.75 | 59.12 | | 14.25 | 56.00 | 66.75 | 25.50 | 3.38 | 32 | 4280 | 10529 |
| 58 | 75.00 | 8.75 | 9.12 | 63.00 | 61.12 | | 14.56 | 58.00 | 68.75 | 26.00 | 3.38 | 32 | 4640 | 11414 |
| 60 | 78.50 | 9.19 | 9.56 | 65.25 | 63.38 | | 15.31 | 60.00 | 71.75 | 27.25 | 3.62 | 28 | 5000 | 13108 |

To be specified by Purchaser.

DIMENSIONS ARE IN INCHES / WEIGHTS ARE IN POUNDS

(A) Bolt lengths are calculated based on bolting one WN to one Blind

(B) Bolt diameter should be 1/8" less than the bolt hole diameter

(C) Larger sizes as well as intermediate sizes can be furnished

B16.47 Series A Class 900 Weld Neck & Blind

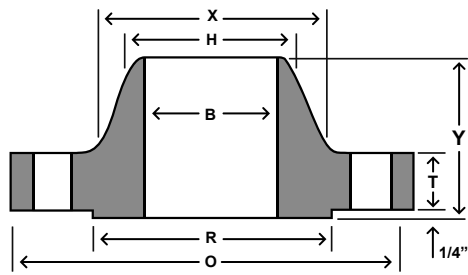

WELD NECK

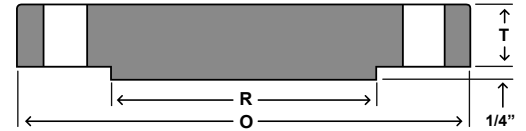

BLIND

| Nom Size | Thickness | | | OD of RF | Dia at Base | Bore | LTH | Dia Bevel | Bolt Circle | | | | Weight | |
|----------|-----------|-----------|-------|----------|-------------|------|-------|-----------|-------------|-------------|----------|------------|-----------|-------|
| | OD | Weld Neck | Blind | | | | | | | Bolt Length | Hole Dia | # of Holes | Weld Neck | Blind |
| | O | T | T | | | | | | | R | X | B | Y | H |
| 26 | 42.75 | 5.50 | 6.31 | 29.50 | 30.50 | | 11.25 | 26.00 | 37.50 | 18.75 | 2.88 | 20 | 1525 | 2566 |
| 28 | 46.00 | 5.62 | 6.75 | 31.50 | 32.75 | | 11.75 | 28.00 | 40.25 | 19.75 | 3.12 | 20 | 1810 | 3178 |
| 30 | 48.50 | 5.88 | 7.18 | 33.75 | 35.00 | | 12.25 | 30.00 | 42.75 | 20.50 | 3.12 | 20 | 2120 | 3758 |
| 32 | 51.75 | 6.25 | 7.62 | 36.00 | 37.25 | | 13.00 | 32.00 | 45.50 | 22.00 | 3.38 | 20 | 2545 | 4541 |
| 34 | 55.00 | 6.50 | 8.06 | 38.00 | 39.62 | | 13.75 | 34.00 | 48.25 | 23.00 | 3.62 | 20 | 2970 | 5425 |
| 36 | 57.50 | 6.75 | 8.44 | 40.25 | 41.88 | | 14.25 | 36.00 | 50.75 | 23.75 | 3.62 | 20 | 3395 | 6209 |
| 38 | 57.50 | 7.50 | 8.50 | 43.25 | 42.25 | | 13.88 | 38.00 | 50.75 | 24.50 | 3.62 | 20 | 3385 | 6253 |
| 40 | 59.50 | 7.75 | 8.81 | 45.75 | 44.38 | | 14.31 | 40.00 | 52.75 | 25.00 | 3.62 | 24 | 3620 | 6940 |
| 42 | 61.50 | 8.12 | 9.12 | 47.75 | 46.31 | | 14.62 | 42.00 | 54.75 | 25.75 | 3.62 | 24 | 3960 | 7675 |
| 44 | 64.88 | 8.44 | 9.56 | 50.00 | 48.62 | | 15.38 | 44.00 | 57.62 | 27.00 | 3.88 | 24 | 4300 | 8954 |
| 46 | 68.25 | 8.88 | 10.06 | 52.50 | 50.88 | | 16.18 | 46.00 | 60.50 | 28.50 | 4.12 | 24 | 4640 | 10426 |
| 48 | 70.25 | 9.19 | 10.38 | 54.50 | 52.88 | | 16.50 | 48.00 | 62.50 | 29.00 | 4.12 | 24 | 4980 | 11398 |

To be specified by Purchaser.

DIMENSIONS ARE IN INCHES / WEIGHTS ARE IN POUNDS

(A) Bolt lengths are calculated based on bolting one WN to one Blind

(B) Bolt diameter should be 1/8" less than the bolt hole diameter

(C) Larger sizes as well as intermediate sizes can be furnished