

B16.47 Series B Class 75 Weld Neck & Blind

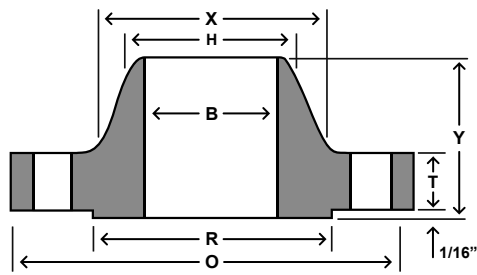

WELD NECK

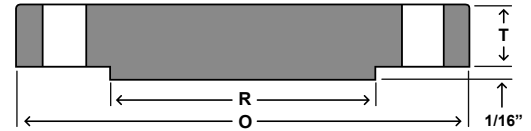

BLIND

Nom Size	Thickness								Drilling				Weight	
	OD	Weld Neck	Blind	OD of RF	Dia at Base	Bore	LTH	Dia Bevel	Bolt Circle	Bolt Length	Hole Dia	# of Holes	Weld Neck	Blind
	O	T	T	R	X	B	Y	H		(A)	(B)			
26	30.00	1.25	1.25	27.75	26.62		2.25	26.06	28.50	4.50	0.75	36	80	255
28	32.00	1.25	1.25	29.75	28.62		2.38	28.06	30.50	4.50	0.75	40	85	290
30	34.00	1.25	1.25	31.75	30.62		2.50	30.06	32.50	4.50	0.75	44	90	330
32	36.00	1.32	1.38	33.75	32.62		2.69	32.06	34.50	4.75	0.75	48	105	390
34	38.00	1.32	1.44	35.75	34.62		2.82	34.06	36.50	4.75	0.75	52	110	430
36	40.69	1.38	1.61	38.00	36.81		3.32	36.06	39.06	5.25	0.88	40	145	518
38	42.69	1.44	1.69	40.00	38.81		3.44	38.06	41.06	5.50	0.88	40	160	595
40	44.69	1.44	1.69	42.00	40.81		3.57	40.06	43.06	5.50	0.88	44	170	760
42	46.69	1.50	1.82	44.00	42.81		3.69	42.06	45.06	5.50	0.88	48	185	895
44	49.25	1.63	1.88	46.25	44.88		4.07	44.06	47.38	6.00	1.00	36	230	1065
46	51.25	1.69	1.94	48.25	46.88		4.19	46.06	49.38	6.25	1.00	40	245	1185
48	53.25	1.75	2.07	50.25	48.88		4.32	48.06	51.38	6.50	1.00	44	270	1315
50	55.25	1.82	2.13	52.25	50.94		4.50	50.06	53.38	6.50	1.00	44	290	1505
52	57.38	1.82	2.19	54.25	52.94		4.69	52.06	55.50	6.75	1.00	48	310	1665
54	59.38	1.88	2.32	56.25	55.00		4.88	54.06	57.50	6.75	1.00	48	340	1840
56	62.00	1.94	2.38	58.50	57.12		5.25	56.06	59.88	7.25	1.12	40	400	2110
58	64.00	2.00	2.44	60.50	59.12		5.38	58.06	61.88	7.25	1.12	44	430	2300
60	66.00	2.13	2.57	62.50	61.12		5.63	60.06	63.88	7.75	1.12	44	475	2500

To be specified by Purchaser.

DIMENSIONS ARE IN INCHES / WEIGHTS ARE IN POUNDS

(A) Bolt lengths are calculated based on bolting one WN to one Blind

(B) Bolt diameter should be 1/8" less than the bolt hole diameter

(C) Larger sizes as well as intermediate sizes can be furnished

B16.47 Series B Class 150 Weld Neck & Blind

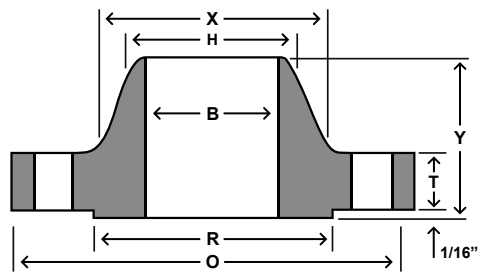

WELD NECK

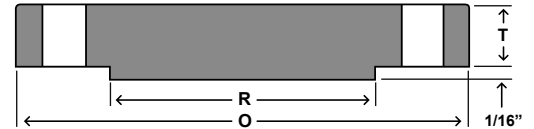

BLIND

Nom Size	Thickness								Drilling				Weight	
	OD	Weld Neck	Blind	OD of RF	Dia at Base	Bore	LTH	Dia Bevel	Bolt Circle	Bolt Length	Hole Dia	# of Holes	Weld Neck	Blind
	O	T	T	R	X	B	Y	H		(A)	(B)			
26	30.94	1.57	1.69	28.00	26.94		3.44	26.06	29.31	5.50	0.88	36	120	373
28	32.94	1.69	1.82	30.00	28.94		3.69	28.06	31.31	5.75	0.88	40	140	454
30	34.94	1.69	1.94	32.00	31.00		3.88	30.06	33.31	6.00	0.88	44	150	543
32	37.06	1.75	2.07	34.00	33.06		4.19	32.06	35.44	6.25	0.88	48	170	648
34	39.56	1.88	2.19	36.25	35.12		4.28	34.06	37.69	6.75	1.00	40	210	783
36	41.62	2.00	2.25	38.25	37.19		4.57	36.06	39.75	6.75	1.00	44	240	890
38	44.25	2.07	2.44	40.25	39.25		4.82	38.12	42.12	7.50	1.12	40	290	1089
40	46.25	2.13	2.57	42.50	41.31		5.00	40.12	44.12	7.75	1.12	44	310	1247
42	48.25	2.25	2.63	44.50	43.38		5.19	42.12	46.12	7.75	1.12	48	345	1393
44	50.25	2.32	2.75	46.50	45.38		5.32	44.12	48.12	8.00	1.12	52	370	1579
46	52.81	2.38	2.88	48.62	47.44		5.63	46.12	50.56	8.50	1.25	40	435	1824
48	54.81	2.50	3.00	50.75	49.50		5.82	48.12	52.56	8.75	1.25	44	480	2045
50	56.81	2.63	3.13	52.75	51.50		6.00	50.12	54.56	9.00	1.25	48	520	2284
52	58.81	2.69	3.25	54.75	53.56		6.13	52.12	56.56	9.25	1.25	52	550	2547
54	61.00	2.75	3.38	56.75	55.62		6.32	54.12	58.75	9.50	1.25	56	620	2848
56	63.00	2.82	3.50	58.75	57.69		6.50	56.12	60.75	9.75	1.25	60	650	3144
58	65.94	2.88	3.62	60.75	59.69		6.82	58.12	63.44	10.00	1.38	48	780	3560
60	67.94	2.94	3.75	63.00	61.81		7.00	60.12	65.44	10.25	1.38	52	850	3913

To be specified by Purchaser.

DIMENSIONS ARE IN INCHES | WEIGHTS ARE IN POUNDS

(A) Bolt lengths are calculated based on bolting one WN to one Blind

(B) Bolt diameter should be 1/8" less than the bolt hole diameter

(C) Larger sizes as well as intermediate sizes can be furnished

B16.47 Series B Class 300 Weld Neck & Blind

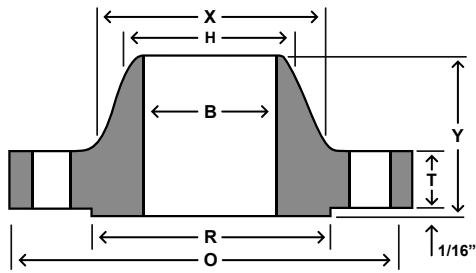

WELD NECK

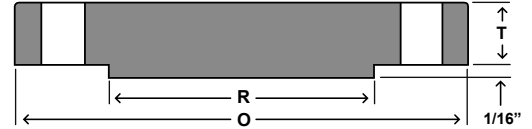

BLIND

Nom Size	Thickness								Drilling				Weight	
	OD	Weld Neck	Blind	OD of RF	Dia at Base	Bore	LTH	Dia Bevel	Bolt Circle	Bolt Length	Hole Dia	# of Holes	Weld Neck	Blind
	O	T	T	R	X	B	Y	H		(A)	(B)			
26	34.12	3.44	3.44	29.00	27.62		5.63	26.19	31.62	10.50	1.38	32	400	907
28	36.25	3.44	3.44	31.00	29.75		5.81	28.19	33.75	10.50	1.38	36	450	1023
30	39.00	3.63	3.63	33.25	32.00		6.16	30.25	36.25	11.25	1.50	36	550	1249
32	41.50	4.00	4.00	35.50	34.00		6.56	32.25	38.50	12.00	1.62	32	685	1556
34	43.62	4.00	4.00	37.50	36.12		6.75	34.25	40.62	12.00	1.62	36	750	1719
36	46.12	4.00	4.00	39.75	38.00		7.06	36.25	42.88	12.50	1.75	32	840	1921
38	48.12	4.31	4.31	41.75	40.00		7.50	38.25	44.88	13.00	1.75	36	915	2257
40	50.12	4.50	4.50	43.88	42.00		7.75	40.25	46.88	13.50	1.75	40	990	2549
42	52.50	4.63	4.63	46.00	44.00		8.00	42.31	49.00	14.00	1.88	36	1135	2876
44	54.50	4.94	4.94	48.00	46.19		8.38	44.31	51.00	14.50	1.88	40	1235	3304
46	57.50	5.00	5.06	50.00	48.38		8.69	46.31	53.75	15.00	2.00	36	1470	3766
48	59.50	5.00	5.25	52.25	50.31		8.75	48.31	55.75	15.25	2.00	40	1575	4183
50	61.50	5.38	5.44	54.25	52.38		9.19	50.31	57.75	15.75	2.00	44	1710	4629
52	63.50	5.56	5.61	56.25	54.44		9.50	52.31	59.75	16.00	2.00	48	1840	5096
54	65.88	5.32	5.81	58.25	56.50		9.38	54.31	62.12	16.00	2.00	48	1980	5678
56	69.50	6.00	6.12	60.50	58.81		10.50	56.31	65.00	17.75	2.38	36	2595	6642
58	71.94	6.00	6.31	62.75	60.94		10.75	58.31	67.44	18.00	2.38	40	2770	7347
60	73.94	5.88	6.50	65.00	62.94		10.63	60.31	69.44	18.00	2.38	40	2870	7980

To be specified by Purchaser.

DIMENSIONS ARE IN INCHES / WEIGHTS ARE IN POUNDS

(A) Bolt lengths are calculated based on bolting one WN to one Blind

(B) Bolt diameter should be 1/8" less than the bolt hole diameter

(C) Larger sizes as well as intermediate sizes can be furnished

B16.47 Series B Class 400 Weld Neck & Blind

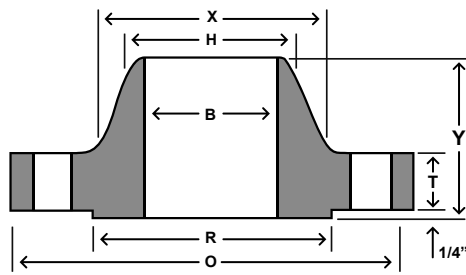

WELD NECK

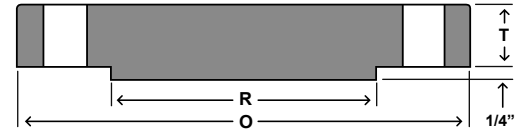

BLIND

Nom Size	Thickness						Drilling					Weight		
	OD	Weld Neck	Blind	OD of RF	Dia at Base	Bore	LTH	Dia Bevel	Bolt Circle	Bolt Length	Hole Dia	# of Holes	Weld Neck	Blind
	O	T	T	R	X	B	Y	H		(A)	(B)			
26	33.50	3.50	3.50	28.00	27.12		5.88	26.00	30.75	11.25	1.50	28	360	874
28	36.00	3.75	3.75	30.00	29.12		6.25	28.00	33.00	12.00	1.62	24	450	1081
30	38.25	4.00	4.00	32.25	31.25		6.69	30.00	35.25	12.50	1.62	28	530	1302
32	40.75	4.25	4.25	34.38	33.25		7.06	32.00	37.50	13.25	1.75	28	635	1570
34	42.75	4.38	4.38	36.50	35.38		7.38	34.00	39.50	13.50	1.75	32	690	1781
36	45.50	4.69	4.69	38.62	37.50		7.88	36.00	42.00	14.50	1.88	28	855	2160
38	47.50	4.88	4.88	40.75	39.50		8.12	38.00	44.00	14.75	1.88	32	935	2450
40	50.00	5.12	5.12	43.00	41.50		8.50	40.00	46.25	15.50	2.00	32	1090	2848
42	52.00	5.25	5.25	45.00	43.62		8.81	42.00	48.25	15.75	2.00	32	1190	3159
44	54.50	5.50	5.50	47.25	45.62		9.18	44.00	50.50	16.50	2.12	32	1375	3635
46	56.75	5.75	5.75	49.50	47.75		9.62	46.00	52.75	17.00	2.12	36	1525	4120
48	59.50	6.00	6.00	51.50	49.88		10.12	48.00	55.25	18.00	2.38	28	1790	4726
50	61.75	6.19	6.25	53.62	52.00		10.56	50.00	57.50	18.50	2.38	32	1950	5303
52	63.75	6.38	6.44	55.62	54.00		10.88	52.00	59.50	18.75	2.38	32	2125	5823
54	67.00	6.69	6.75	57.88	56.12		11.38	54.00	62.25	20.00	2.62	28	2565	6742
56	69.00	6.88	6.94	60.12	58.25		11.75	56.00	64.25	20.25	2.62	32	2710	7352
58	71.00	7.00	7.12	62.12	60.25		12.06	58.00	66.25	20.50	2.62	32	3230	7986
60	74.25	7.31	7.44	64.38	62.38		12.56	60.00	69.00	21.75	2.88	32	3820	9126

To be specified by Purchaser.

DIMENSIONS ARE IN INCHES / WEIGHTS ARE IN POUNDS

(A) Bolt lengths are calculated based on bolting one WN to one Blind

(B) Bolt diameter should be 1/8" less than the bolt hole diameter

(C) Larger sizes as well as intermediate sizes can be furnished

B16.47 Series B Class 600 Weld Neck & Blind

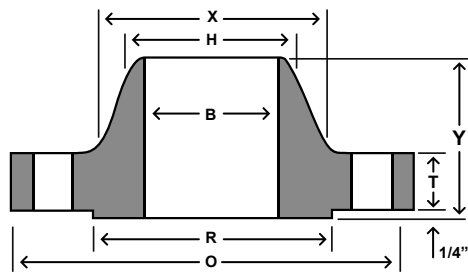

WELD NECK

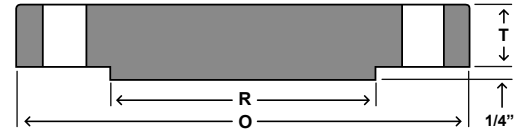

BLIND

Nom Size	Thickness								Drilling				Weights	
	OD	Weld Neck	Blind	OD of RF	Dia at Base	Bore	LTH	Dia Bevel	Bolt Circle	Bolt Length	Hole Dia	# of Holes	Weld Neck	Blind
	O	T	T	R	X	B	Y	H		(A)	(B)			
26	35.00	4.38	4.38	28.62	27.50		7.12	26.00	31.75	13.50	1.75	28	550	1194
28	37.50	4.56	4.56	30.88	29.62		7.50	28.00	34.00	14.25	1.88	28	650	1427
30	40.25	4.94	5.00	33.12	31.75		8.06	30.00	36.50	15.25	2.00	28	810	1802
32	42.75	5.12	5.31	35.25	33.88		8.50	32.00	38.75	16.00	2.12	28	950	2159
34	45.75	5.56	5.68	37.50	36.00		9.19	34.00	41.50	17.25	2.38	24	1205	2645
36	47.75	5.75	5.94	39.75	38.12	To be specified by Purchaser.	9.56	36.00	43.50	17.75	2.38	28	1340	3013
38	50.00	6.00	6.12	41.50	40.25		10.00	38.00	45.75	18.25	2.38	28	1470	3404
40	52.00	6.25	6.38	43.75	42.25		10.38	40.00	47.75	18.75	2.38	32	1630	3838
42	55.25	6.62	6.75	46.00	44.38		11.00	42.00	50.50	19.75	2.62	28	2030	4585
44	57.25	6.81	7.00	48.25	46.50		11.38	44.00	52.50	20.25	2.62	32	2160	5105
46	59.50	7.06	7.31	50.25	48.62		11.81	46.00	54.75	20.75	2.62	32	2410	5758
48	62.75	7.44	7.69	52.50	50.75		12.44	48.00	57.50	22.25	2.88	32	2855	6737
50	65.75	7.75	8.00	54.50	52.88		12.94	50.00	60.00	23.25	3.12	28	3330	7695
52	67.75	8.00	8.25	56.50	54.88		13.25	52.00	62.00	23.75	3.12	32	3560	8426
54	70.00	8.25	8.56	58.75	57.00		13.75	54.00	64.25	24.25	3.12	32	3920	9333
56	73.00	8.56	8.88	60.75	59.12		14.25	56.00	66.75	25.50	3.38	32	4280	10,529
58	75.00	8.75	9.12	63.00	61.12		14.56	58.00	68.75	26.00	3.38	32	4640	11,414
60	78.50	9.19	9.56	65.25	63.38		15.31	60.00	71.75	27.25	3.62	28	5000	13,108

DIMENSIONS ARE IN INCHES | WEIGHTS ARE IN POUNDS

(A) Bolt lengths are calculated based on bolting one WN to one Blind

(B) Bolt diameter should be 1/8" less than the bolt hole diameter

(C) Larger sizes as well as intermediate sizes can be furnished

B16.47 Series B Class 900 Weld Neck & Blind

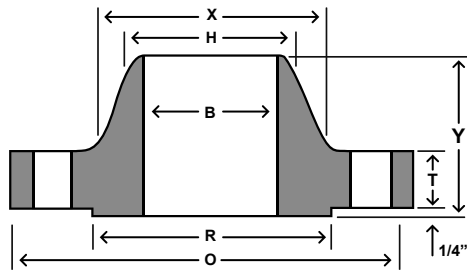

WELD NECK

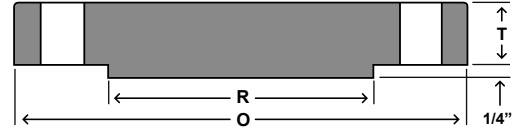

BLIND

Nom Size	Thickness			OD of RF	Dia at Base	Bore	LTH	Dia Bevel	Drilling				Weights	
	OD	Weld Neck	Blind						Bolt Circle	Bolt Length	Hole Dia	# of Holes	Weld Neck	Blind
	O	T	T						R	X	B	Y	H	(A)
26	40.25	5.31	6.06	30.00	29.25		10.19	26.00	35.50	17.75	2.62	20	1050	2184
28	43.50	5.81	6.56	32.25	31.38		10.88	28.00	38.25	19.50	2.88	20	1520	2762
30	46.50	6.12	6.93	34.50	33.50		11.38	30.00	40.75	20.50	3.12	20	1820	3334
32	48.75	6.31	7.31	36.50	35.75		11.94	32.00	43.00	21.00	3.12	20	2065	3865
34	51.75	6.75	7.68	39.00	37.88		12.56	34.00	45.50	22.50	3.38	20	2450	4576
36	53.00	6.81	7.94	40.50	40.00		12.81	36.00	47.25	22.25	3.12	24	2520	4963
38	57.50	7.50	8.50	43.25	42.25		13.88	38.00	50.75	24.50	3.62	20	3385	6253
40	59.50	7.75	8.81	45.75	44.38		14.31	40.00	52.75	25.00	3.62	24	3620	6940
42	61.50	8.12	9.12	47.75	46.31		14.62	42.00	54.75	25.75	3.62	24	3960	7675
44	64.88	8.44	9.56	50.00	48.62		15.38	44.00	57.62	27.00	3.88	24	4300	8954
46	68.25	8.88	10.06	52.50	50.88		16.18	46.00	60.50	28.50	4.12	24	4640	10,426
48	70.25	9.19	10.38	54.50	52.88		16.50	48.00	62.50	29.00	4.12	24	4980	11,398

To be specified by Purchaser.

DIMENSIONS ARE IN INCHES / WEIGHTS ARE IN POUNDS

(A) Bolt lengths are calculated based on bolting one WN to one Blind

(B) Bolt diameter should be 1/8" less than the bolt hole diameter

(C) Larger sizes as well as intermediate sizes can be furnished