

ASTM A105 Carbon steel BLRF Flange

Drawing

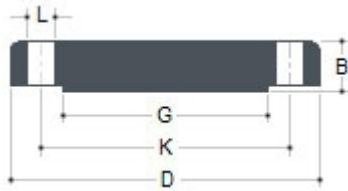

Dimension

DIMENSIONS of CLASS 150 FLANGES AS PER ANSI B 16.5							
NB		D	B	G	K	L	No. of Holes
½"	15	88.9	11.1	34.9	60.3	15.9	4
¾"	20	98.4	12.7	42.9	69.8	15.9	4
1"	25	107.9	14.3	50.8	79.4	15.9	4
1 ¼"	32	117.5	15.9	63.5	88.9	15.9	4
1 ½"	40	127.0	17.5	73.0	98.4	15.9	4
2"	50	152.4	19.0	92.1	120.6	19.0	4
2 ½"	65	177.8	22.2	104.8	139.7	19.0	4
3"	80	190.5	23.8	127.0	152.4	19.0	4
4"	100	230.0	23.8	157.2	190.5	19.0	8
5"	125	254.0	23.8	185.7	215.9	22.2	8
6"	150	279.4	25.4	215.9	241.3	22.2	8
8"	200	342.9	28.6	269.9	298.4	22.2	8
10"	250	406.4	30.2	323.8	361.9	25.4	12
12"	300	482.6	31.8	381.0	431.8	25.4	12
14"	350	533.4	34.9	412.7	476.2	28.6	12
16"	400	596.9	36.5	469.9	539.7	28.6	16
18"	450	635.0	39.7	533.4	577.8	31.7	16
20"	500	698.5	42.9	584.2	635.0	31.7	20
24"	600	812.8	47.6	692.1	749.3	34.9	20

DIMENSIONS of CLASS 300 FLANGES AS PER ANSI B 16.5							
NB		D	B	G	K	L	No. of Holes
½"	15	95.2	14.3	34.9	66.7	15.9	4
¾"	20	117.5	15.9	42.9	82.5	19.0	4
1"	25	123.8	17.5	50.8	88.9	19.0	4
1 ¼"	32	133.3	19.0	63.5	98.4	19.0	4
1 ½"	40	155.6	20.6	73.0	114.3	22.2	4
2"	50	165.1	22.2	92.1	127.0	19.0	8
2 ½"	65	190.5	25.4	104.8	149.2	22.2	8
3"	80	209.5	28.6	127.0	168.3	22.2	8
4"	100	254.0	31.8	157.2	200.0	22.2	8
5"	125	279.4	34.9	185.7	234.9	22.2	8
6"	150	317.5	36.5	215.9	269.9	22.2	12
8"	200	381.0	41.3	269.9	330.2	25.4	12
10"	250	444.5	47.6	323.8	387.3	28.6	16
12"	300	520.7	50.8	381.0	450.8	31.7	16
14"	350	584.2	54.0	412.7	514.3	31.7	20
16"	400	647.7	57.2	469.9	571.5	34.9	20
18"	450	711.2	60.3	533.4	628.5	34.9	24
20"	500	774.7	63.5	584.2	685.8	34.9	24
24"	600	914.4	69.8	692.1	812.8	41.3	24

DIMENSIONS of CLASS 600 FLANGES AS PER ANSI B 16.5							
NB		D	B	G	K	L	No. of Holes
1/2"	15	95.2	14.3	34.9	66.7	15.9	4
3/4"	20	117.5	15.9	42.9	82.5	19.0	4
1"	25	123.8	17.5	50.8	88.9	19.0	4
1 1/4"	32	133.3	20.6	63.5	98.4	19.0	4
1 1/2"	40	155.6	22.2	73.0	114.3	22.2	4
2"	50	165.1	25.4	92.1	127.0	19.0	8
2 1/2"	65	190.5	28.6	104.8	149.2	22.2	8
3"	80	209.5	31.8	127.0	168.3	22.2	8
4"	100	273.0	38.1	157.2	215.9	25.4	8
5"	125	330.2	44.4	185.7	266.7	28.6	8
6"	150	355.6	47.6	215.9	292.1	28.6	12
8"	200	419.1	55.6	269.9	349.2	31.7	12
10"	250	508.0	63.5	323.8	431.8	34.9	16
12"	300	558.8	66.7	381.0	488.9	34.9	20
14"	350	603.2	69.9	412.7	527.0	38.1	20
16"	400	685.8	75.2	469.9	603.2	41.3	20
18"	450	742.9	82.6	533.4	654.0	44.4	20
20"	500	812.8	88.9	584.2	723.9	44.4	24
24"	600	939.8	101.6	692.1	838.2	50.8	24

All dimensions are in millimeters unless indicated.