

Class 150 Stainless Steel Weld Neck Flange

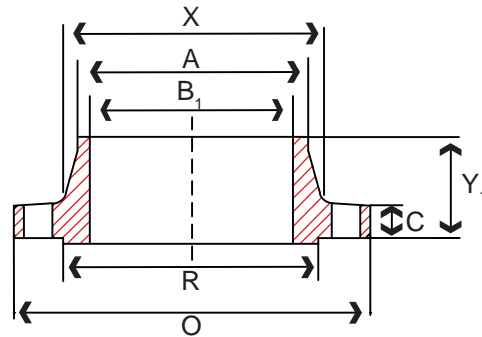

Stainless Steel Weld Neck Flange

Class 150 Stainless Steel Weld Neck Flange Dimensions

| Nominal Size | Common Dimensions | | | | Weld Neck Socket (b ₁) | Bore | | Length Thru Hub | | |
|--------------|----------------------|---------------|--------------------------|-------------------|------------------------------------|---------------------------|-----------------------------|-----------------------------|----------------------------------|-----------------------------|
| | Outside Diameter (D) | Thickness (C) | Raised Face Diameter (R) | Fillet Radius (r) | | Slip-on (b ₂) | Lap Joint (b ₃) | Weld Neck (Y ₁) | Slip-on Socket (Y ₂) | Lap Joint (Y ₃) |
| 1/2 | 3.50 | 0.44 | 1.38 | 0.12 | To be specified by purchaser. | 0.88 | 0.90 | 1.88 | 0.62 | 0.62 |
| 3/4 | 3.88 | 0.50 | 1.69 | 0.12 | | 1.09 | 1.11 | 2.06 | 0.62 | 0.62 |
| 1 | 4.25 | 0.56 | 2.00 | 0.12 | | 1.36 | 1.38 | 2.19 | 0.69 | 0.69 |
| 1-1/4 | 4.62 | 0.62 | 2.50 | 0.19 | | 1.70 | 1.72 | 2.25 | 0.81 | 0.81 |
| 1-1/2 | 5.00 | 0.69 | 2.88 | 0.25 | | 1.95 | 1.97 | 2.44 | 0.88 | 0.88 |
| 2 | 6.00 | 0.75 | 3.62 | 0.31 | | 2.44 | 2.46 | 2.50 | 1.00 | 1.00 |
| 2-1/2 | 7.00 | 0.88 | 4.12 | 0.31 | | 2.94 | 2.97 | 2.75 | 1.12 | 1.12 |
| 3 | 7.50 | 0.94 | 5.00 | 0.38 | | 3.57 | 3.60 | 2.75 | 1.19 | 1.19 |
| 3-1/2 | 8.50 | 0.94 | 5.50 | 0.38 | | 4.07 | 4.10 | 2.81 | 1.25 | 1.25 |
| 4 | 9.00 | 0.94 | 6.19 | 0.44 | | 4.60 | 4.60 | 3.00 | 1.31 | 1.31 |
| 5 | 10.00 | 0.94 | 7.31 | 0.44 | | 5.66 | 5.69 | 3.50 | 1.44 | 1.44 |
| 6 | 11.00 | 1.00 | 8.50 | 0.50 | | 6.72 | 6.75 | 3.50 | 1.56 | 1.56 |
| 8 | 13.50 | 1.12 | 10.62 | 0.50 | | 8.72 | 8.75 | 4.00 | 1.75 | 1.75 |
| 10 | 16.00 | 1.19 | 12.75 | 0.50 | | 10.88 | 10.92 | 4.00 | 1.94 | 1.94 |
| 12 | 19.00 | 1.25 | 15.00 | 0.50 | | 12.88 | 12.92 | 4.50 | 2.19 | 2.19 |
| 14 | 21.00 | 1.38 | 16.25 | 0.50 | | 14.14 | 14.18 | 5.00 | 2.25 | 3.12 |
| 16 | 23.50 | 1.44 | 18.50 | 0.50 | 16.16 | 16.19 | 5.00 | 2.50 | 3.44 | |
| 18 | 25.00 | 1.56 | 21.00 | 0.50 | 18.18 | 18.20 | 5.50 | 2.69 | 3.81 | |
| 20 | 27.50 | 1.69 | 23.00 | 0.50 | 20.20 | 20.25 | 5.69 | 2.88 | 4.06 | |
| 24 | 32.00 | 1.88 | 27.25 | 0.50 | 24.25 | 24.25 | 6.00 | 3.25 | 4.38 | |

Note: OEM services are available as per customer's request